

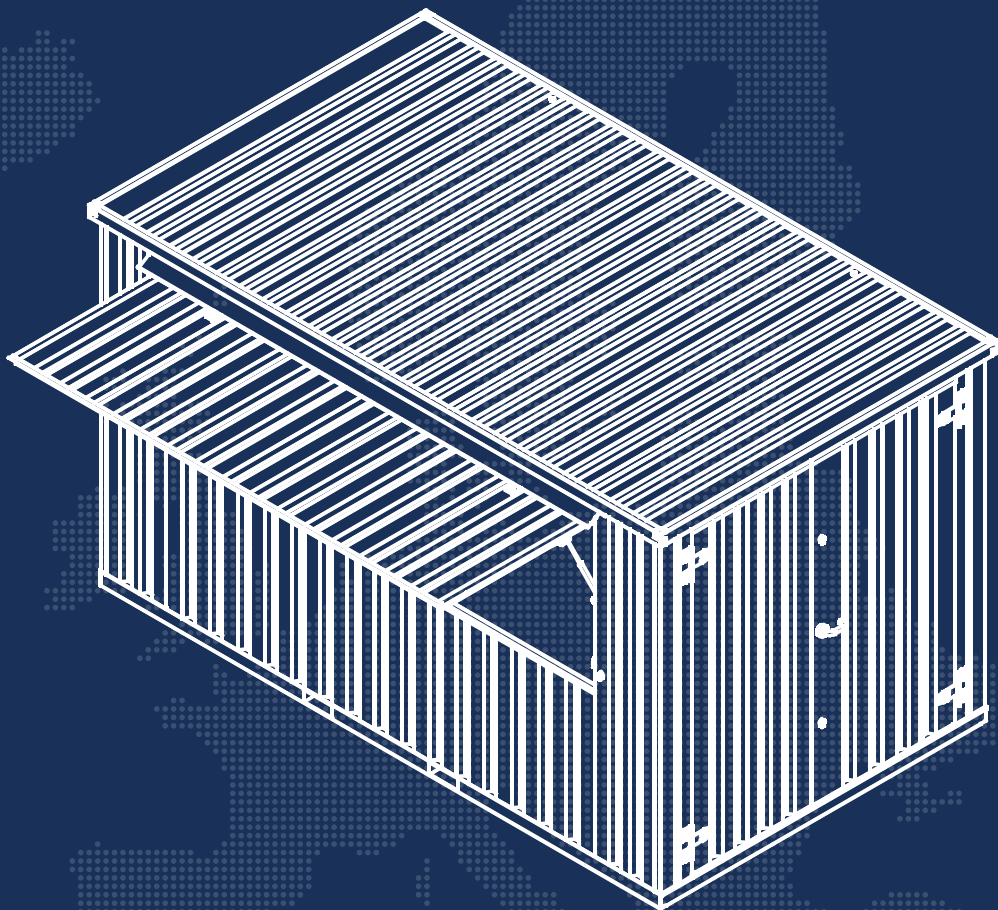

FOCO[®]
CONTAINERS

ASSEMBLY INSTRUCTIONS

Bar Container



Tools needed:



- Screwdriver or drill (Phillips head)
- 13 mm wrench
- 19 mm wrench
- Torque wrench (13 mm and 19 mm attachments)

Assembly Manual:



First, use the 19 mm and 13 mm wrenches to remove the screws that hold the floor and roof packages together. the roof package together, and save these screws. Also unscrew and save the Lifting lugs on the roof and save them.

Then remove the wood blocks at the corners of the package and the iron blocks in the center, these are not required for assembly, but may be useful when leveling the container.





Then remove the panels from the packaging, do not place them on the asphalt, as this may cause damage in the form of dents or scratches. Protect the plates with wood or plastic scraps in front of the package. Always mount a container on a flat surface.



The plates are then placed in the correct position (see illustration above). These are mounted with the 13 mm and 19 mm screws from the package with an appropriate washer between them (photo below). During assembly, the plates must be held by an additional person so that they do not be held so that they cannot fall to the floor. fall to the floor. fall to the floor. Once the panels are secured to the ground, they can be released, provided there is no wind. The side panels (walls) are installed first, followed by the door.





Then the two plates are fixed with a 13 mm bolt, a nut and two washers. The screw is fixed with the nut in the holes with a washer on both sides for protection. At each corner of the container are three mounting holes, in which a screw should be inserted.

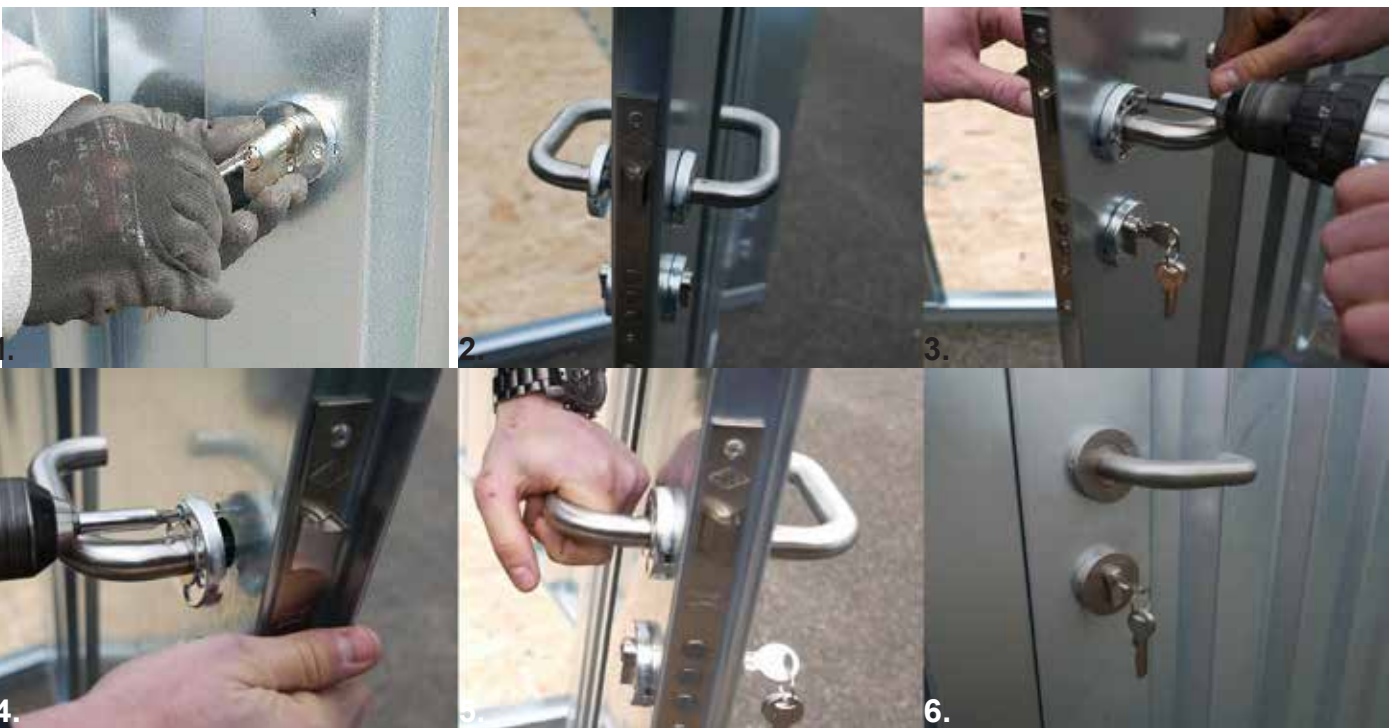

With the key, the cylinder lock is attached (photo 1). Next, attach the door handle (photo 2), which must be screwed on both sides with 3 screws (photo 3 + 4). Then the lock is attached to the side of the door with the long screw (photo 5). Finally, the metal protectors are attached to each latch and keyhole (photo 6).





The roof should be set up with (at least) four people. First, all stand next to the container and then simultaneously lift the roof over your head. Place the roof up to about halfway on top of the container. Half the people then go into the container, lift the roof through and lay it properly. The roof lies correctly when it has fallen completely into the slots.



Next, mount the roof with a 13 mm bolt, a nut and two washers, as shown in the picture above.



Now screw the rain gutter to the top of the awning plate with three screws, it is best to have someone outside holds the screws and someone else tightens them inside.





Now attach the handles to the cap with the remaining screws. There are three holes. Make sure make sure that the handles are attached on the outside at the top and on the inside at the bottom, as shown in the figure below. The handles should be attached from the outside and inside.



Finally, the crane lugs are reattached to the container roof, for which no tools are required. tools are required.

